

2MY-2HTM

(WITH INTEGRATED 3-PHASE MOTOR)

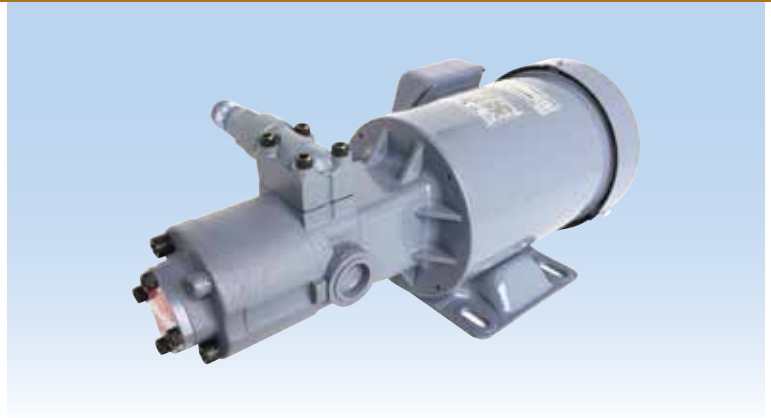

Model Numbering System (For Diesel Oil Kerosene Heavy Oil)

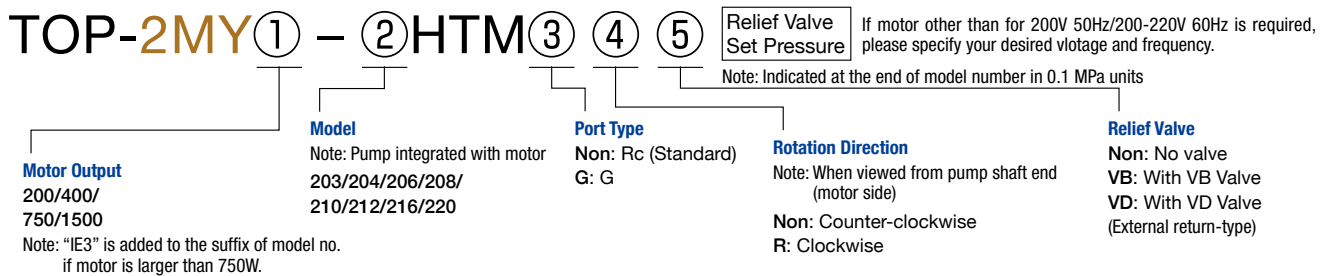

Specifications

Model	Item	Motor speed 50Hz 1500min ⁻¹				Motor speed 60Hz 1800min ⁻¹					
		Theoretical discharge (l/min)	Max. pressure for motor output (MPa)				Theoretical discharge (l/min)	Max. pressure for motor output (MPa)			
			200W	400W	750W	1500W		200W	400W	750W	1500W
TOP-203HTM		4.2	0.7	0.7	0.7	0.7	5.0	0.7	0.7	0.7	0.7
TOP-204HTM		6.0	0.7	0.7	0.7	0.7	7.2	0.7	0.7	0.7	0.7
TOP-206HTM		9.0	0.7	0.7	0.7	0.7	10.8	0.6	0.7	0.7	0.7
TOP-208HTM		12.0	0.6	0.7	0.7	0.7	14.4	0.4	0.7	0.7	0.7
TOP-210HTM		15.0	0.5	0.7	0.7	0.7	18.0	0.3	0.7	0.7	0.7
TOP-212HTM		18.0	0.4	0.7	0.7	0.7	21.6	0.2	0.7	0.7	0.7
TOP-216HTM		24.0	0.3	0.7	0.7	0.7	28.8	–	0.6	0.7	0.7
TOP-220HTM		30.0	–	0.6	0.7	0.7	36.0	–	0.5	0.7	0.7

• Test oil: ISO-VG2/Oil temperature: 40C

Motor Specifications

- 3-phase squirrel-cage induction motor
- Totally enclosed
- Class E insulation (200W, 400W)
- Class F insulation (750W, 1500W)
- Protection level IP44

Output (W)	Number of poles (P)	Rating	200V class				400V class				Approx. Weight (Kg)
			Voltage (V)	Frequency (Hz)	Motor Speed (min ⁻¹)	Current (A)	Voltage (V)	Frequency (Hz)	Motor Speed (min ⁻¹)	Current (A)	
200	4	Cont	200	50	1440	1.34	380	50	1440	0.64	6.5
			200	60	1720	1.12	400	50	1440	0.67	
			220	60	1730	1.17	400	60	1720	0.56	
400	4	Cont	200	50	1420	2.20	380	50	1420	1.08	9.0
			200	60	1710	1.93	400	50	1430	1.11	
			220	60	1730	1.95	400	60	1710	0.96	
750	4	Cont	200	50	1440	3.30	400	50	1440	1.77	14.0
			200	60	1720	3.10	400	60	1730	1.61	
			220	60	1740	3.00	440	60	1760	1.57	
1500	4	Cont	200	50	1450	6.90	400	50	1450	3.40	22.0
			200	60	1740	6.20	400	60	1740	3.10	
			220	60	1750	6.00	440	60	1750	3.00	

• Please consult us when ordering outdoor-type, increased safety-type, special voltage type or one with CE marking, terminal box attached on the other side, or other special motors.
• 750W and 1500W motors comply with requirements of IE3, CE marking and class F insulation. *Please consult us if motor other than for standard voltage is required.

Any disassembly or alteration of the product will void the warranty.